

Premium Booth 3mW x 4mD One side open

LT-B-12
3mW x 4mD x 3.5mH

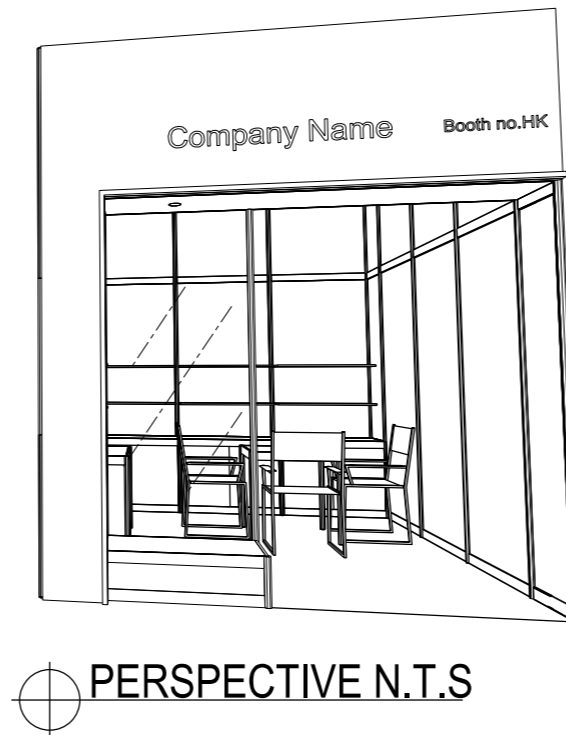

COLOUR PERSPECTIVE N.T.S

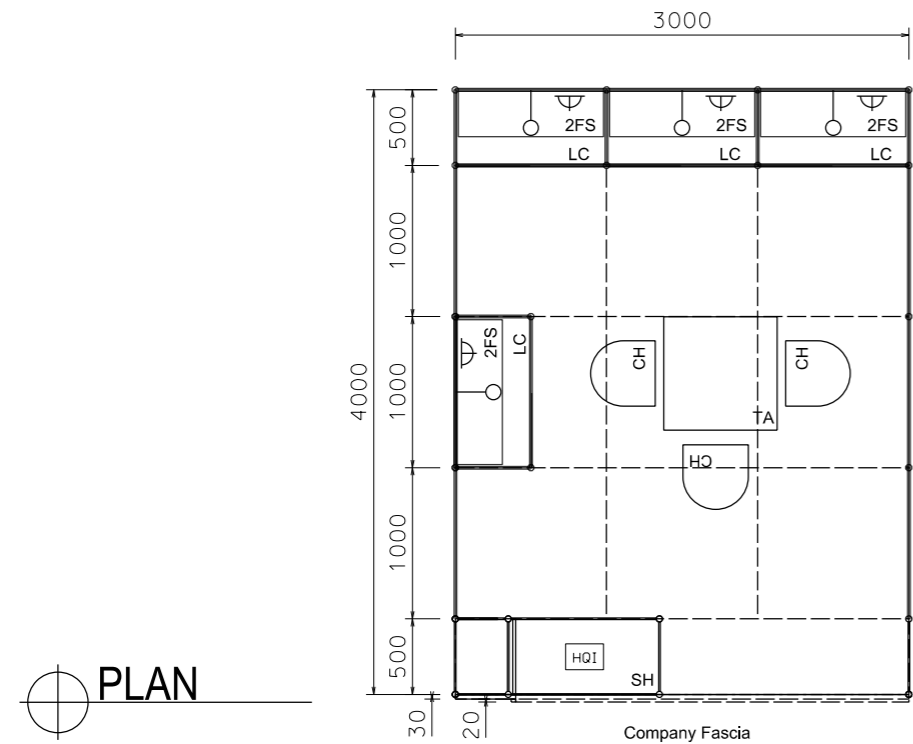
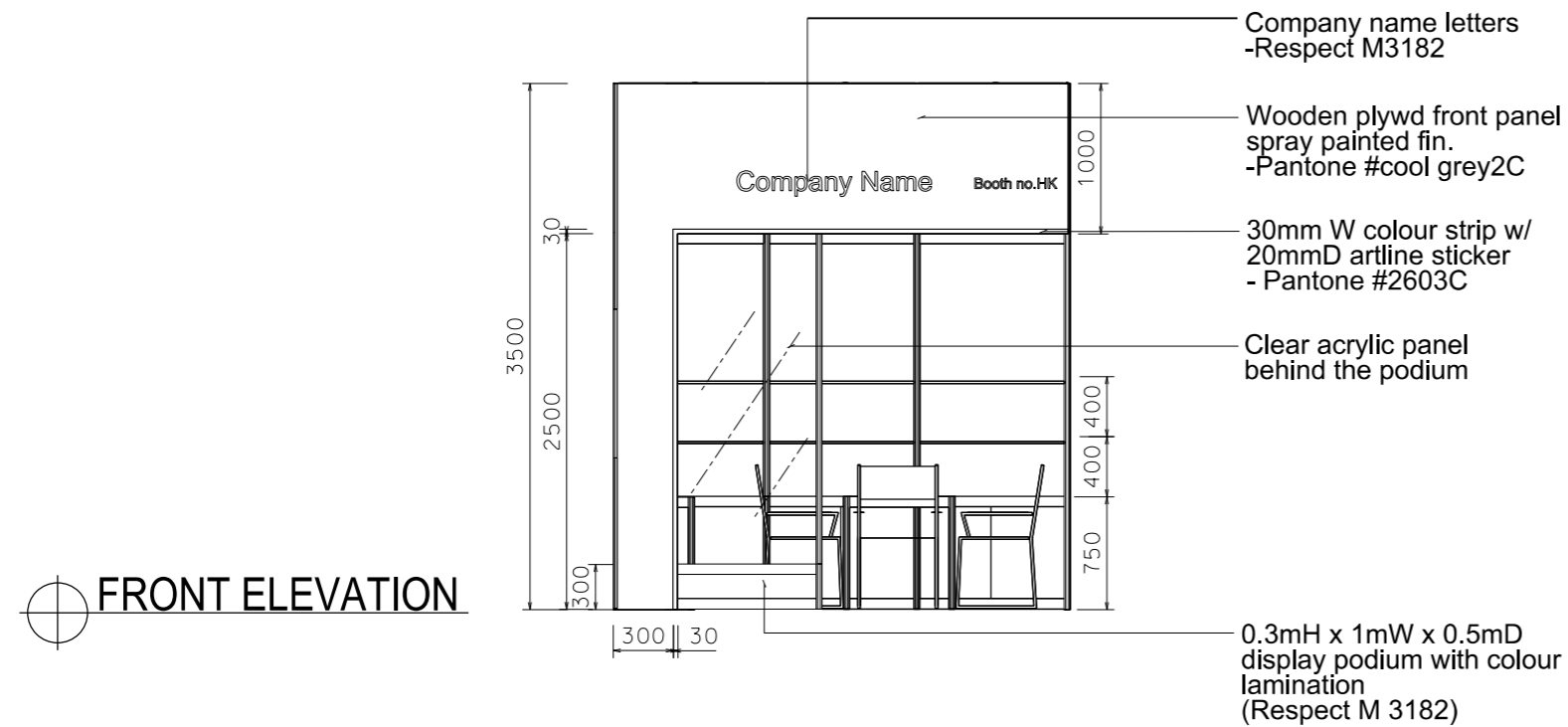

BOOTH SPECIFICATION		QTY
	Front display podium (1mW x 0.3mH) with clear acrylic back panel in colour sticker lamination w/ 1 x HQI white light	1
	Lockable cabinet (1mL x 0.5mD x 0.75mH)	4
	Wooden shelf (flat) (1mL x 0.3mD)	8
	Square meeting table (0.7m X0.7m x 0.75mH)	1
	Black leather chair	3
	Longarmed spotlight w/23 watt energy saving lamp (yellow) set at 3.5mH	4
	800w Square pin power socket	4
	Ceiling grid (175mmH) set at 3.5mH	19m



NOTES UNLESS OTHERWISE SPECIFIED ALL DIMENSIONS ARE IN MM.

.....

.....

.....

REVISION
02/09/2009
23/09/2009
02/10/2009
22/12/2009
28/12/2009
13/04/2011
23/10/2013
16/06/2014
18/07/2014

DATE:	18-07-2014
SCALE:	1 : 50 (A3)
DRAWN BY:	..
CHECKED BY:

TITLE
Premium Booth
LT-B-12

PROJECT
PREMIUM BOOTH
3m x 4m
DATE: XXXXXXXX

SHEET
LT-B05

FILE PATH - L:\Local Fair Premium Booth 2011\LT-B layout\LT-B-2d\layout_update.dgn