

Hong Kong International Lighting Fair (Autumn Edition)

香港國際秋季燈飾展

3M x 3M Peninsula Booth (SPECIAL ZONE)

三米乘三米半島攤位

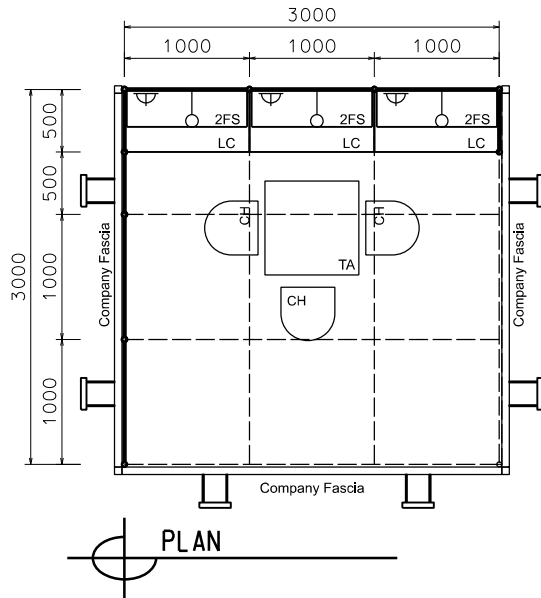

BLACK SYSTEM BEAM

FROSTED
ACRYLIC

WOODEN FASCIA W/
SPRAY PAINT FIN.

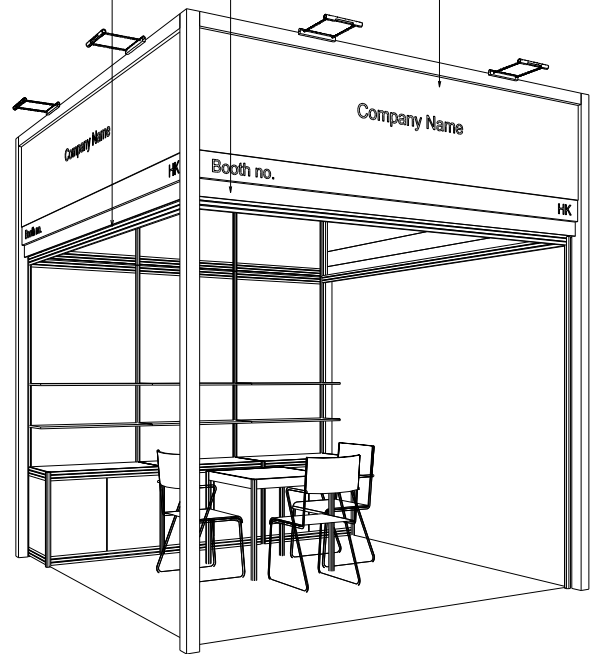

PERSPECTIVE

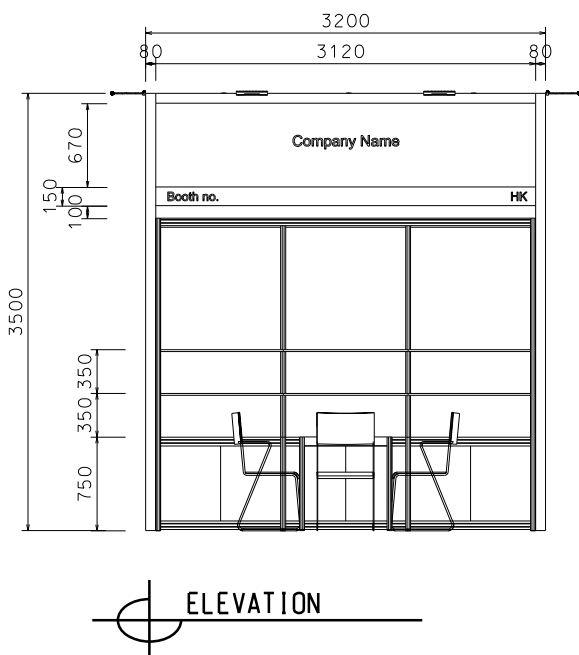

ELEVATION

BOOTH SPECIFICATIONS		QTY.
	1000W x 500D x 750H CABINET	3
	3000W x 300D WOODEN DISPLAY SHELF	2
	700W x 700D x 750H MEETING TABLE	1
	BLACK LEATHER CHAIR	3
	GILBERT LAMP	6
	13W LED LAMP LONGARMED SPOTLIGHT (YELLOW LIGHT) SET AT 3500mmH	3
	800W SOCKET	3
	CEILING GRID (175mmH) SET AT 3.5mmH	12M
	RUBBISH BIN & CARPET (9sqm.)	